

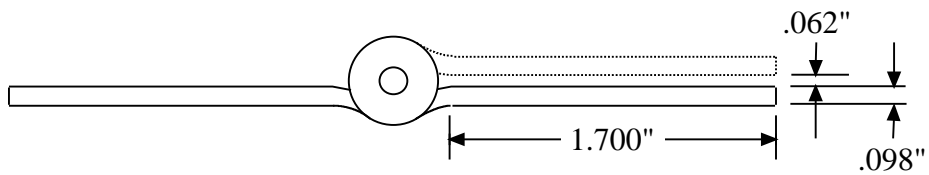

### Full mortise P non-template light weight hinge

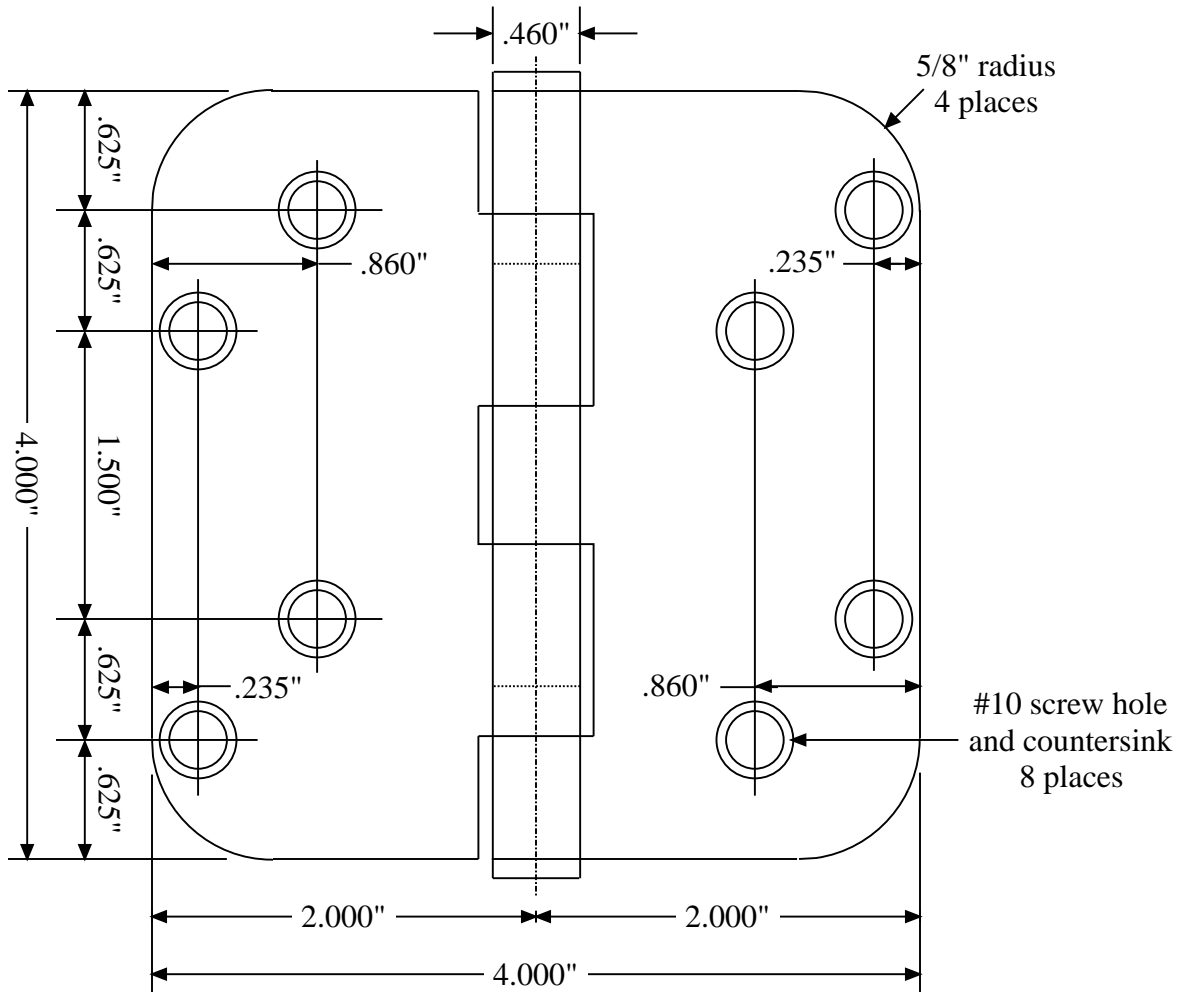

	Part Number
Plain bearing steel	RP8P4040R5
Plain bearing stainless	RP5P4040R5
Ball bearing steel	RB8P4040R5
Ball bearing stainless	RB5P4040R5

Standard screws: 4 #10-24 x 1/2" machine and 8 #10 x 1" wood screws per hinge.